

TYPE K - MEASURING PROBE (NICR-NI) WITH DIN-TYPE FLAT-PIN PLUG

-65 °C
+500 °C

GOF 501

Art. no. 475077

Surface probe for solid with silver measuring surface
-65 ... +500 °C

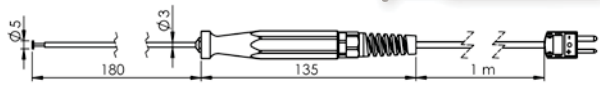

for any straight and solid surface; fixed silver plate, plastic handle, anti-buckling glanding, 1 m silicone cable, miniature flat plug

Response time T₉₀: approx. 3 s

-65 °C
+500 °C

GOF 501 HO

Art. no. 475072

Surface probe with silver measuring surface, angled
-65 ... +500 °C

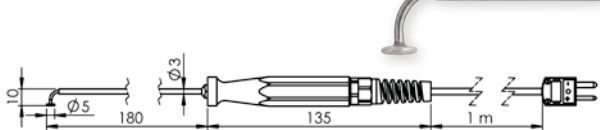

for any straight and solid surface, small elbow-type, fixed silver plate, plastic handle, anti-buckling glanding, 1 m silicone cable, miniature flat plug

Response time T₉₀: approx. 3 s

-65 °C
+500 °C

GOF 130 CU

Art. no. 600486

Surface probe for solid surfaces, fast
-65 ... +500 °C

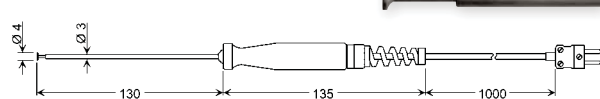

for any straight and solid surface
Spring-loaded copper plate, plastic handle, anti-buckling glanding, 1 m silicone cable, miniature flat plug

Response time T₉₀: approx. 5 s

-65 °C
+500 °C

GES 20-K

Art. no. 602591

Core temperature- / food probe with compact teflon handle
-65 ... +500 °C



Use for canteen kitchen, bakeries, butcher's shops, etc.
V4A tube with Ø 1.5 mm slim insertion tip, small Teflon handle, stainless steel kink protection, 1 m Teflon cable, miniature flat plug

Response time T₉₀: water 0.4 m/s < 1 s, air 2 m/s approx. 12 s

-50 °C
+250 °C

GES 21-K

Art. no. 600074

Core temperature- / food probe
-50 ... +250 °C, potential free

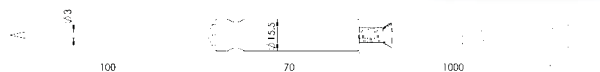

Use for canteen kitchen, bakeries, butcher's shops, etc.
V4A tube Ø 3 mm with needle-shaped insertion tip, big white teflon handle, stainless steel kink protection, 1 m Teflon cable, miniature flat plug

Response time T₉₀: water 0.4 m/s < 2 s, air 2 m/s approx. 40 s

-65 °C
+550 °C

GES 130

Art. no. 600514

Insertion probe for soft media
-65 ... +550 °C

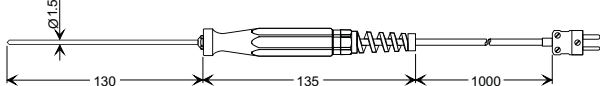

V4A tube with Ø 1.5 mm slim insertion tip, plastic handle, anti-buckling glanding, 1 m silicone cable, miniature flat plug

Response time T₉₀: water 0.4 m/s approx. 1 s, air 2 m/s approx. 1.5 s

-65 °C
+550 °C

GES 500

Art. no. 600516

Insertion probe for soft media
-65 ... +550 °C

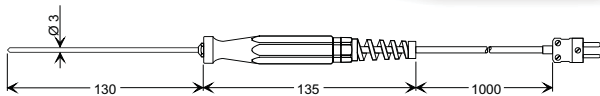

V4A tube with Ø 3 mm with needle-shaped insertion tip, plastic handle, anti-buckling glanding, 1 m silicone cable, miniature flat plug

Response time T₉₀: water 0.4 m/s < 2 s

-65 °C
+1000 °C

GES 900

Art. no. 600518

Insertion probe for soft media
-65 ... +1000 °C

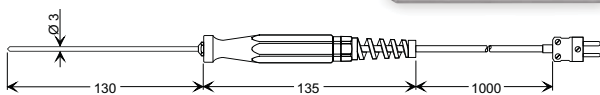

Spring-loaded V4A tube with slim Ø 3 mm insertion tip, plastic handle, anti-buckling glanding, 1 m silicone cable, miniature flat plug

Response time T₉₀: water 0.4 m/s approx. 5 s

-65 °C
+600 °C

GTL 130

Art. no. 602304

Air / gas probe
-65 ... +600 °C

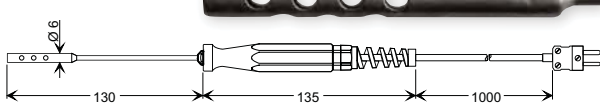

for room temperature, flue gases, etc.
perforated V4A protective tube, fused thermocouple wires arranged behind, plastic handle, anti-buckling glanding, 1 m silicone cable, miniature flat plug

Response time T₉₀: air 2 m/s approx. 15 s

-65 °C
+200 °C

GKF 125

Art. no. 600520

Probe for compost, grain
-65 ... +200 °C

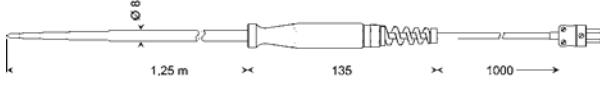

split-second response time, yet highly resilient
V4A tube Ø 8 mm reduced to Ø 3 mm at the front, plastic handle, anti-buckling glanding, 1 m silicone cable, miniature flat plug

Response time T₉₀: water 0.4 m/s approx. 6 s

-50 °C
+250 °C

GTF 40 K-620

Art. no. 610829

Stainless steel insertion probe, t-handle
-50 ... +250 °C, Type K, class 1, FL 620 mm

GTF 40 K-1000

Art. no. 475184

Stainless steel insertion probe, t-handle
-50 ... +250 °C, Type K, class 1, FL 1000 mm

GTF 40 K-1500

Art. no. 475185

Stainless steel insertion probe, t-handle
-50 ... +250 °C, Type K, class 1, FL 1500 mm



Stainless steel tube with 10 mm diameter and insertion tip, robust and ergonomic stainless steel T-handle, anti-buckling glanding, 1 m silicone cable, miniature flat plug

Response time T₉₀: water 0.4 m/s approx. 6 s